

# DISCOVER | Professional Display

# Quick Start Guide

DIS-xx10 Series



\*Image shown here is indicative only. If there is any inconsistency between the image and the actual product you receive, the actual product will govern.

Thank you for supporting this product.

This quick user guide will help you safely connect and use Discover Professional Display. If you have any question, please refer to the instruction.

## **Safety Warning**

### Placement

The unit should be turned clockwise (regular front view perspective) when used in portrait mode.

Do not place the unit on an unstable cart, stand, tripod, bracket, table, or shelf.

Do not expose the unit to direct sunlight and other sources of heat.

Do not put the unit near appliances that generate magnetic fields.

Do not handle liquids near or on the unit.

Never spill liquid of any kind into the unit.

Do not put heavy objects on top of the unit.

### Power Supply

Check that the unit's operating voltage is identical with the your local power supply.

Please unplug power supply and aerial plug when the weather is thunder-storm or lightning.

Please unplug power supply, when there is nobody at home or don't use over a long period of time.

Please keep power cord from physical or mechanical damage.

Please use exclusive power cord, don't modify or lengthen it.

Please check and ensure AC source is connected with the ground.

### LED Screen

Unplug the power supply before cleaning.

Clean the screen with a soft, dustless and dry cloth.

Never use water or the spray type detergent to clean the unit.

For deep clean, contact an authorized service center.

Please don't display the high brightness image on the screen for a long time.

### Sight Distance

The best distance between audience and screen is 3-4 times that of screen diagonal length.

The best watching angle between audience and screen as top and bottom, or so inside 176 degrees.

### Temperature

Do not place the unit near or over a radiator or a heater register.

If your unit is suddenly moved from a cold to a warm place, unplug the power cord for at least two hours to let that moisture may have formed inside the unit can dry completely.

Normal operating temperature is 0 - 40 °C.

### Humidity

Do not expose the unit in rain, damp or place near water.

## Ventilation

Keep the ventilation smoothly.

Ensure that the unit has enough space for ventilation Around: left, right and back >10cm, top> 20cm.

## Earphone

It will effect the hearing while using the earphone listen to noisy sound for a long time.

Before using earphone, please turn down the volume in advance.

## Standby

It will enter standby mode but not tum off the unit when press the standby key.

## Notes for Cleaning

There are heat sinking holese on back cover , do not spray water.

## Power Switch Status Signs

"I" means power on, "O" means power off.

## Notes for Maintenance

This machine can only be maintained by certified engineer.

# Disclaimer

When any of the following cases occurs, the company does not guarantee the liability of free maintenance.

- A. Product damages caused by violating the user guidance.
- B. Hardware damages caused by improper assembly.
- C. Product damages caused by unauthorized modification or maintenance.
- D. Product damages caused by using in unpermitted environment.
- E. Product damages caused by abnormal external force.
- F. Product damages caused by natural disasters or other force majeure.
- G. Privately tear off or damage disassembly tabs.
- H. Unable to provide effective purchase certificate.

## On/Off

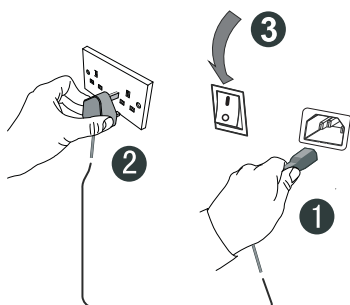

- 1 Plug the power cable into the power socket of the.
- 2 Plug the power cable to the power supply.
- 3 Press the on/off button to startup the unit. "I" means power on, "O" means power off.

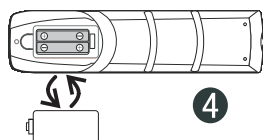

- 4 Remove the cover on the rear of the remote control as shown, insert two AAA equivalent batteries.
- 5 Press the POWER button on the remote control, the indicator at the right bottom shows blue, that means the unit start.

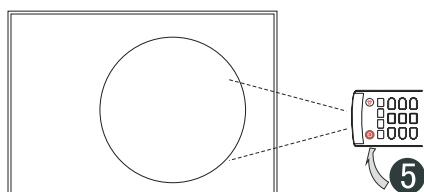





Note: The remote receiver is located at the behind of the panel.



1. Don't use the refresh battery, such as nickel-cadmium cell. For it is different from shape and function, it is hard to ensure the operate accuracy. Please handle the scrap battery in environmental way.
2. Press the power button on the remote control or press the power button for three seconds on the keypad and wait for the unit to shut down. Only after the indicator light turns red, turn off the power switch and disconnect the main power. To avoid disconnecting the power switch or main power when the unit is in normally open mode or the indicator light turning blue. Directly power off may cause damage to the hardware of machines.
3. This device comes standard with a power cord for the device use only, please do not use it for other devices.

## Key & Port Description

The number of buttons and the screen contents of the device, please prevail in kind.

Power indicator light	Display the status of the power supply
	Power on/off button Press into energy-saving,press this button for three second into standby condition
MENU	Pop up Settings menu
INPUT	Pop up channel Setting
	Press to scroll left
	Press to scroll right
	Press to scroll down/Volume down
	Press to scroll up/Volume up

## Connection of common ports

For the number and type of the equipment port, please refer to the actual product. The input source as follow is used just for example.

AUDIO OUT

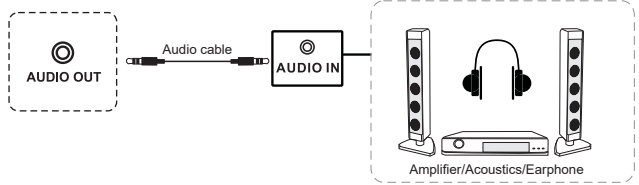

LAN

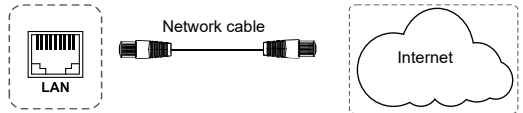

HDMI  
signal input

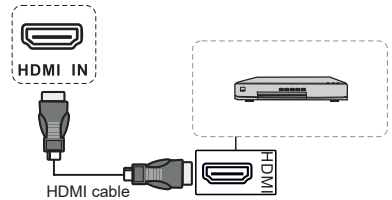

HDMI  
signal output

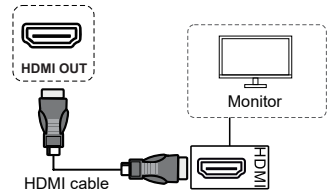

RS232 Connection

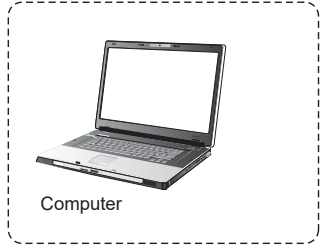

TYPE-C

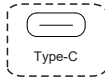

USB

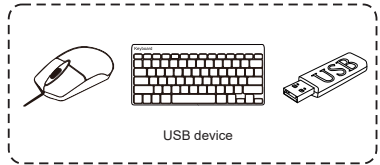
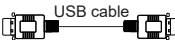
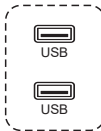

# Maintenance

Proper maintenance can prevent many failures in early stage. Regular careful cleaning can keep the brand new appearance of the unit. Please unplug the power line before cleaning and maintenance in case of electric shock.

## Clean screen

1. Please evenly mix some fabric softener or detergent with alcohol.
2. Please saturate a piece of soft cloth in the mixture above mentioned.
3. Take out the cloth and wring it to half dry and then clean the screen.
4. Repeat the procedures above. Attention: do not drop water into the unit while cleaning.

## Clean front frame

Please choose dry, soft and non-fluff cloth to clean the face frame.

## Non-use of the unit for a long term

If the machine is not used for a long term, please pull out the plug lest lightning or other power supply ripples damage the unit.

### Legamaster International B.V.

Kwinkweerd 62  
P.O. box 111  
7240 AC Lochem  
The Netherlands  
Tel. : (+31) (0)573 - 71 30 00  
Email : [info@legamaster.com](mailto:info@legamaster.com)